



M39029/56 MIL-SPEC ELECTRICAL SOCKET CONTACT

FOR MIL-DTL-38999 SERIES I, III AND IV CONNECTORS

IMAGE	MILITARY PART NUMBER	ELLA ENGINEERING PART NUMBER	PIN/SOCKET	MATING END SIZE	TYPE	CLASS
	M39029/56-348	M056-348-22L	SOCKET	22	A	B
	M39029/56-351	M056-351-20L	SOCKET	20	A	B
	M39029/56-352	M056-352-16L	SOCKET	16	A	B

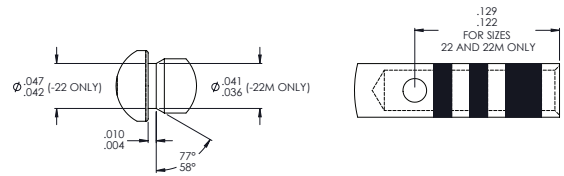
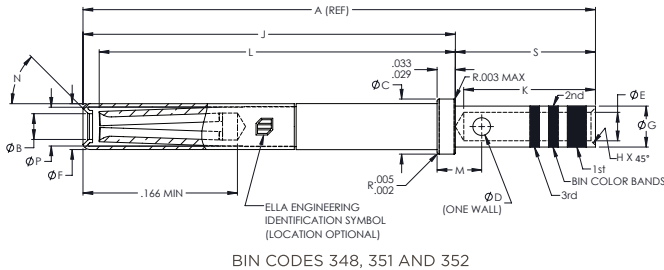

MATERIAL AND FINISH | SOCKET CONTACT: COPPER ALLOY/GOLD PLATED | SOCKET CONTACT HOOD: PASSIVATED STAINLESS STEEL

M39029/56			CONTACT DIMENSIONS								
CONTACT SIZE	MILITARY PART NUMBER	ELLA ENGINEERING PART NUMBER	A (REF)	ØB MIN	ØC	ØD	ØE	ØF MAX	ØG	H	J
22	M39029/56-348	M056-348-22L/LE	.855	.031	.062 .060	.022 .018	.035 .0335	.062	.048 .046	.005 .003	.626 .616
20	M39029/56-351	M056-351-20L	.855	.0415	.094 .091	.032 .026	.048 .046	.078	.070 .068	.010 .005	.626 .616
16	M39029/56-352	M056-352-16L	.855	.064	.130 .127	.042 .036	.068 .066	.113	.103 .101	.010 .005	.626 .616

M39029/56			CONTACT DIMENSIONS (CONTINUED)								
CONTACT SIZE	MILITARY PART NUMBER	ELLA ENGINEERING PART NUMBER	K MIN	L MIN	M	N°	ØP MIN	S	1 ST BAND	2 ND BAND	3 RD BAND
22	M39029/56-348	M056-348-22L/LE	.141	.585	N/A	50° 44°	.047	.237 .231	Orange	Yellow	Gray
20	M39029/56-351	M056-351-20L	.209	.585	.078 .072	47° 40°	.053	.237 .231	Orange	Green	Brown
16	M39029/56-352	M056-352-16L	.209	.585	.088 .082	47° 40°	.084	.237 .231	Orange	Green	Red